

## Automatic Reset Gas Valve

### Features



- EN 161, Class A, Group 2 European approval
- Various AC and DC solenoid voltage options
- Constructed to DIN standards

### Specification

Power supply	230 V ~, 24 - 12 V ~/-
Voltage tolerance	-15% to +10 %
Consumption	16 to 280 W (see table)
Protection	IP 54
Cable Entry	PG 11
Connections:	
GNC ..15 to 50	Female Screwed
GNC ..65 to 100	Flanged PN16
Opening Time	4 seconds
Closure Time	≤ 1 s
Ambient Temp.	-15 °C to + 60 °C
Coil Temperature	Approx. 70 °C
Construction :	
Valve Body	Die cast Aluminium
Seals	NBR (UNI 4916 -74)
Pressure Spring	AISI 302 Steel
Plug	Chromium-Plated Fe 37 Steel
Approval	EN 161, Class A, Group 2

### Product Codes

#### Screwed valves:

<b>VS-GNC-815</b>	1/2" BSP	230Vac coil
<b>VS-GNC-820</b>	3/4" BSP	230Vac coil
<b>VS-GNC-825</b>	1" BSP	230Vac coil
<b>VS-GNC-832</b>	1 1/4" BSP	230Vac coil
<b>VS-GNC-840</b>	1 1/2" BSP	230Vac coil
<b>VS-GNC-850</b>	2" BSP	230Vac coil
<b>VS-GNC-415</b>	1/2" BSP	24Vac/dc coil
<b>VS-GNC-420</b>	3/4" BSP	24Vac/dc coil
<b>VS-GNC-425</b>	1" BSP	24Vac/dc coil
<b>VS-GNC-432*</b>	1 1/4" BSP	24Vac/dc coil
<b>VS-GNC-440*</b>	1 1/2" BSP	24Vac/dc coil
<b>VS-GNC-450*</b>	2" BSP	24Vac/dc coil
<b>VS-GNC-215</b>	1/2" BSP	12Vac/dc coil
<b>VS-GNC-220</b>	3/4" BSP	12Vac/dc coil
<b>VS-GNC-225</b>	1" BSP	12Vac/dc coil
<b>VS-GNC-232*</b>	1 1/4" BSP	12Vac/dc coil
<b>VS-GNC-240*</b>	1 1/2" BSP	12Vac/dc coil
<b>VS-GNC-250*</b>	2" BSP	12Vac/dc coil

#### Flanged valves:

<b>VS-GNC-865</b>	65mm PN16	230Vac coil
<b>VS-GNC-880</b>	80mm PN16	230Vac coil
<b>VS-GNC-8100</b>	100mm PN16	230Vac coil

\* Approved in class "B"

### Technical Overview

The VS-GNC series is a range of normally closed gas solenoid valves. When powered on, the gas valve will open without manual intervention and when powered down will shut off.

### Installation

1. The valve should be installed downstream of the gas meter and outside the area traversed by the gas pipe work.
2. The valve must be protected from rain if installed outside.
3. Pipe work must be clean and free of any residues from soldering, tapping or threading.
4. Valve body is marked with an arrow which indicates the direction of gas flow. Ensure correct orientation.
5. Valve must not be installed with the coil facing downwards. Please see diagram below.
6. Ensure there is sufficient space for circulation of air around the valve and for maintenance access.
7. Use only the valve body for leverage when installing. Levering against the solenoid may cause damage to the coil and the valve stem.

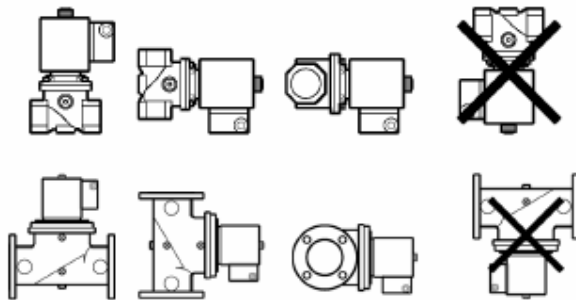

### Connections

The power cable must be connected to the two poles of the rectifier terminal block housed in the wiring box.

The 24V valves on the junction box there are two inputs marked with the symbols "L, N", e " +, -". AC supplies should be connected to 'L' and 'N' whilst DC connects to '+' and '-' observing the correct polarity.

**During normal operation of the gas valve the surface temperature of the coil can reach 70 °C.**

### Pressure Drop

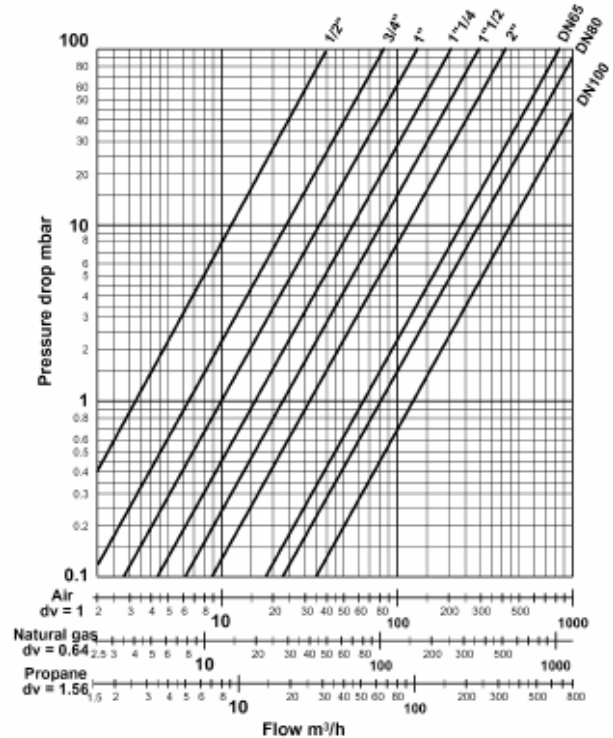

### Dimensions

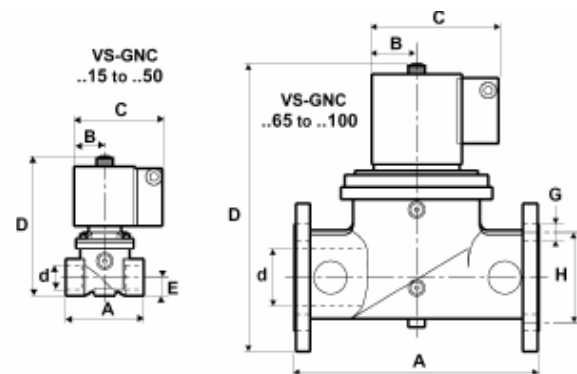

Type	d DN	A mm	B mm	C mm	D mm	E mm	G mm	H mm	Wt kg
..15	1/2"	77	33	96	140	18	-	-	1.4
..20	3/4"	96	44	108	164	25	-	-	2.5
..25	1"	96	44	108	164	25	-	-	2.5
..32	1 1/4"	153	51	128	220	35	-	-	5.7
..40	1 1/2"	153	51	128	220	35	-	-	5.7
..50	2"	156	51	128	230	39	-	-	6
..65	65	308	58	143	355	85	4 x 19	145	13
..80	80	308	58	143	355	85	8 x 19	160	13
..100	100	350	80	188	492	130	8 x 19	180	37

## Specification

Product Code	Connection DN	Supply Voltage	Power W	P.max <sup>(1)</sup> mbar	Orifice Dia. mm	Flow m <sup>3</sup> /h <sup>(2)</sup>		Certification GASTEC PIN:
						0.5mbar	1 mbar	
VS-GNC-815	screw 1/2"	230 V ~	25	200	18	2.8	4	63 AQ 1350 - 10/95
VS-GNC-415	screw 1/2"	24 V ~/-	16	200	18	2.8	4	
VS-GNC-820	screw 3/4"	230 V ~	45	360	27	5.5	8	63 AQ 1350 - 10/95
VS-GNC-420	screw 3/4"	24 V ~/-	30	200	27	5.5	8	
VS-GNC-825	screw 1"	230 V ~	45	360	27	8.3	13	63 AQ 1350 - 10/95
VS-GNC-425	screw 1"	24 V ~/-	30	200	27	8.3	13	
VS-GNC-832	screw 1"1/4	230 V ~	80	360	45	14	20	63 AQ 1350 - 10/95
VS-GNC-432*	screw 1"1/4	24 V ~/-	65	200	45	14	20	
VS-GNC-840	screw 1"1/2	230 V ~	80	360	45	19	28	63 AQ 1350 - 10/95
VS-GNC-440*	screw 1"1/2	24 V ~/-	65	200	45	19	28	
VS-GNC-850	screw 2"	230 V ~	80	360	56	27	40	63 AQ 1350 - 10/95
VS-GNC-450*	screw 2"	24 V ~/-	65	130	56	27	40	
VS-GNC-865	flange 65	230 V ~	190	200	80	55	80	63 AQ 1350 - 10/95
VS-GNC-880	flange 80	230 V ~	190	200	80	73	100	63 AQ 1350 - 10/95
VS-GNC-8100	flange 100	230 V ~	280	200	100	110	160	63 AQ 1350 - 10/95

- (1) Maximum working pressure  
 (2) Natural gas flow with pressure drop of 0.5 mbar or 1 mbar  
 \* Approved in Class "B"