



Features and Benefits

- Ratings from 100 to 800A
- 5A secondary current
- Built in sealable terminal covers

Technical Overview

The PM-CT-M range of moulded case type current transformers are for use with Sontay's PM-EM210 & PM-EM24 kWh meters and other suitable equipment.

They are also supplied with a Din rail clip.

Product Codes

PM-CT-M100	100A Moulded case current transformer
PM-CT-M150	150A Moulded case current transformer
PM-CT-M200	200A Moulded case current transformer
PM-CT-M250	250A Moulded case current transformer
PM-CT-M300	300A Moulded case current transformer
PM-CT-M400	400A Moulded case current transformer
PM-CT-M500	500A Moulded case current transformer
PM-CT-M600	600A Moulded case current transformer
PM-CT-M800	800A Moulded case current transformer

Specification

Overload	1.2 x rated current (continuous)
Rated system voltage	0.72/3kV
Frequency	50/60Hz
Connections	Screw terminals
Ambient:	
Humidity	0 to 95% RH (non-condensing)
Temperature	-30 to +85°C
Conformity:	
BS7626	
IEC185	
BSEN 60044-1	
IEC 60044-1	
Country of origin	UK
Conformity	EMC, LVD, CE & UKCA Marked

Class Rating

	Primary Current (A)	Rating (VA) Class 3
PM-CT-M100	100	2.5
PM-CT-M150	150	2.5
PM-CT-M200	200	5
PM-CT-M250	250	5
PM-CT-M300	300	5
PM-CT-M400	400	5
PM-CT-M500	500	10
PM-CT-M600	600	10
PM-CT-M800	800	10

WEEE Directive:



At the end of the products useful life please dispose as per the local regulations.
Do not dispose of with normal household waste.
Do not burn.



Dimensions

PM-CT-M100, PM-CT-M150 & PM-CT-M200:

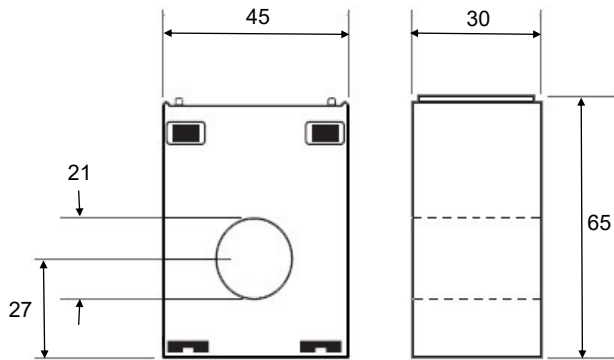

PM-CT-M250, PM-CT-M-300 & PM-CT-M400:

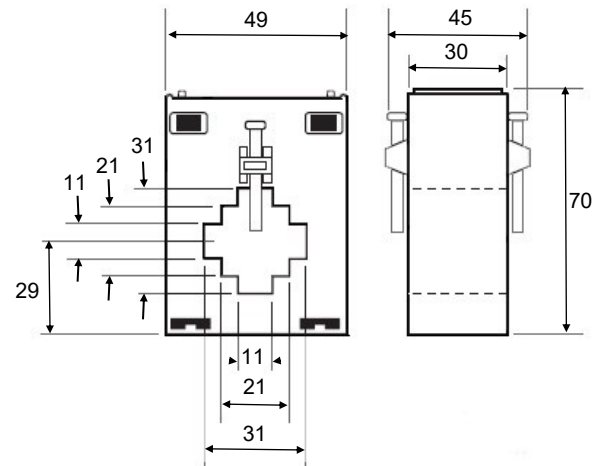

PM-CT-M500, PM-CT-M600 & PM-CT-M800:

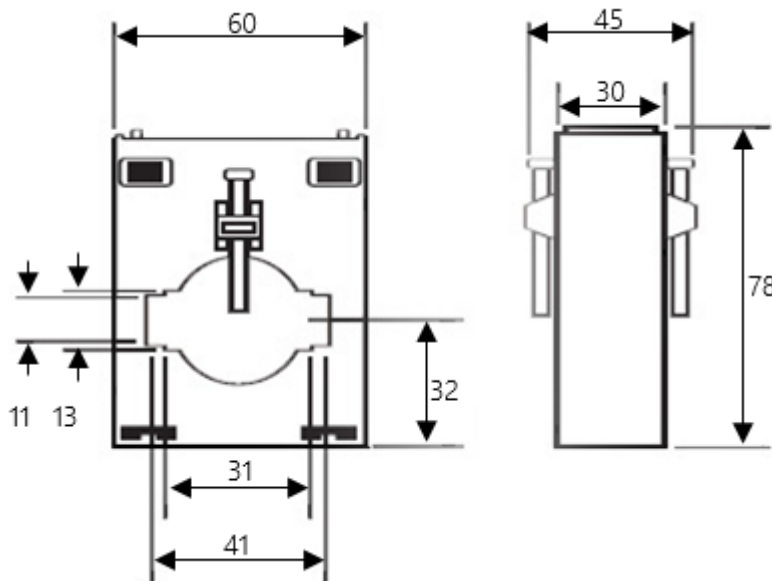

Whilst every effort has been made to ensure the accuracy of this specification, Sontay cannot accept responsibility for damage, injury, loss or expense resulting from errors or omissions. In the interest of technical improvement, this specification may be altered without notice.